

NUTGRADE\_1

" A " COARSE THREAD		" A " FINE THREAD		" B " WIDTH ACROSS FLATS		" C " THICKNESS		" D " FLANGE DIA.	
SIZE	PART NO.	SIZE	PART NO.	MAX.	MIN.	MAX.	MIN.	MAX.	MIN.
10-24	RF1024TFZ	10-32	RF1032TFZ	.375	.365	.219	.203	.500	.480
1/4-20	SF1420TFZ	1/4-28	---	.438	.428	.236	.222	.560	.530
1/4-20	RF1420TFZ	1/4-28	---	.438	.428	.236	.222	.594	.574
5/16-18	RF51618TFZ	5/16-24	RF51624TFZ	.500	.489	.283	.268	.680	.660
3/8-16	RF3816TFZ	3/8-24	RF3824TFZ	.562	.551	.347	.330	.750	.728
7/16-14	RF71614TFZ	7/16-20	---	.688	.675	.395	.375	.937	.910
1/2-13	RF1213TFZ	1/2-20	RF1220TFZ	.750	.736	.458	.437	1.031	1.000
5/8-11	RF5811TFZ	5/8-18	RF5818TFZ	.938	.922	.569	.545	1.330	---
3/4-10	RF3410TFZ	3/4-16	---	1.125	1.088	.675	.627	1.585	---
1-8	RF18TFZ	1-14	RF114TFZ	1.500	1.450	.900	.850	2.060	---

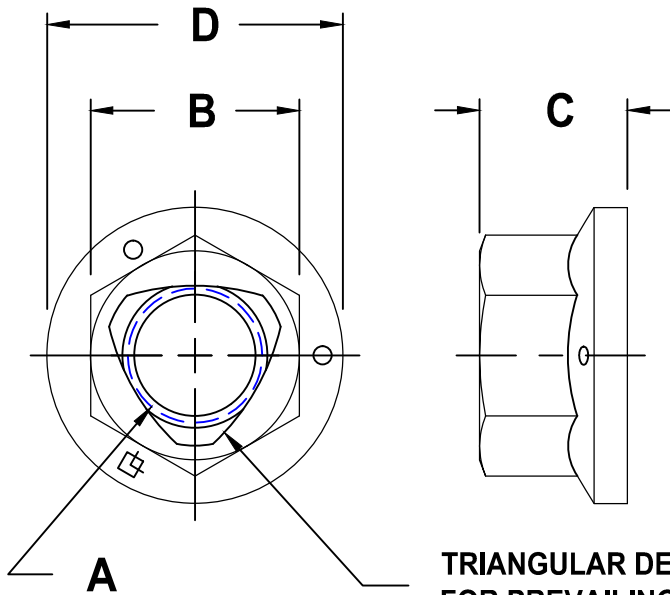

TRIANGULAR DEPRESSION FOR PREVAILING TORQUE SHAPE AS SHOWN

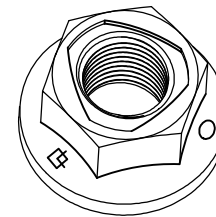

NOTES:

1 - MECHANICAL AND PERFORMANCE REQUIREMENTS PER IFI 100/107

\* COMMON FINISHES LISTED - OTHER FINISHES AVAILABLE

**FLANGE NUT**

**TOP LOCK**

**GRADE F**

**LOCKNUT TECHNOLOGY INC.**

SCALE	UNITS	DWG TYPE	REV
NONE	INCH	S	NONE