

GRADE F - ZINC / YELLOW PLATED *

" A " COARSE THREAD		" B " WIDTH ACROSS FLATS		" C " THICKNESS		" D " FLANGE DIA.
SIZE	PART NO.	MAX.	MIN.	MAX.	MIN.	MAX.
1/4-20	NF1420FZY	.438	.428	.236	--	.560
5/16-18	NF51618FZY	.500	.489	.283	--	.680
3/8-16	NF3816FZY	.562	.551	.347	--	.810
1/2-13	NF1213FZY	.750	.736	.458	--	1.070

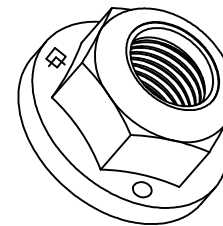
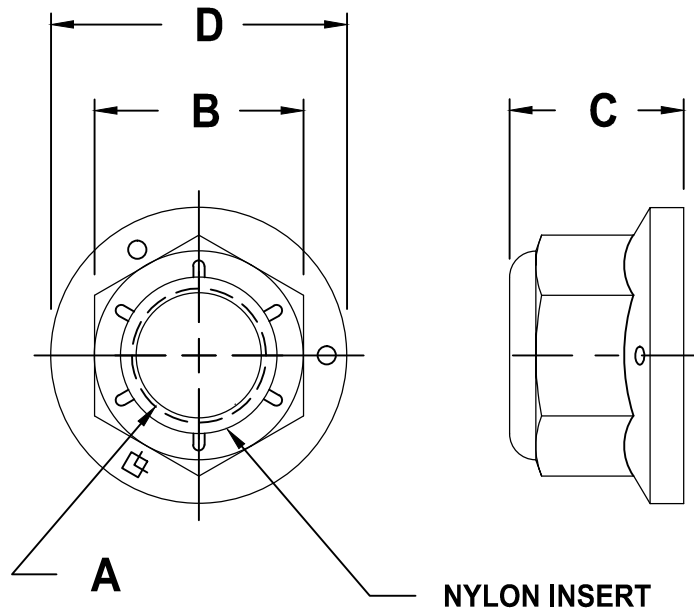

NOTES:

1 - MECHANICAL AND PERFORMANCE REQUIREMENTS PER IFI 100/107

* COMMON FINISHES LISTED - OTHER FINISHES AVAILABLE

**FLANGE NYLON
INSERT LOCKNUTS
GRADE F**

**LOCKNUT
TECHNOLOGY INC.**

SCALE	UNITS	DWG TYPE	REV
NONE	INCH	S	NONE